

Street Map of Boca Grande Neighborhoods

Gasparilla Island, Florida
 Directly on the Gulf of Mexico
 at the mouth of Charlotte Harbor.

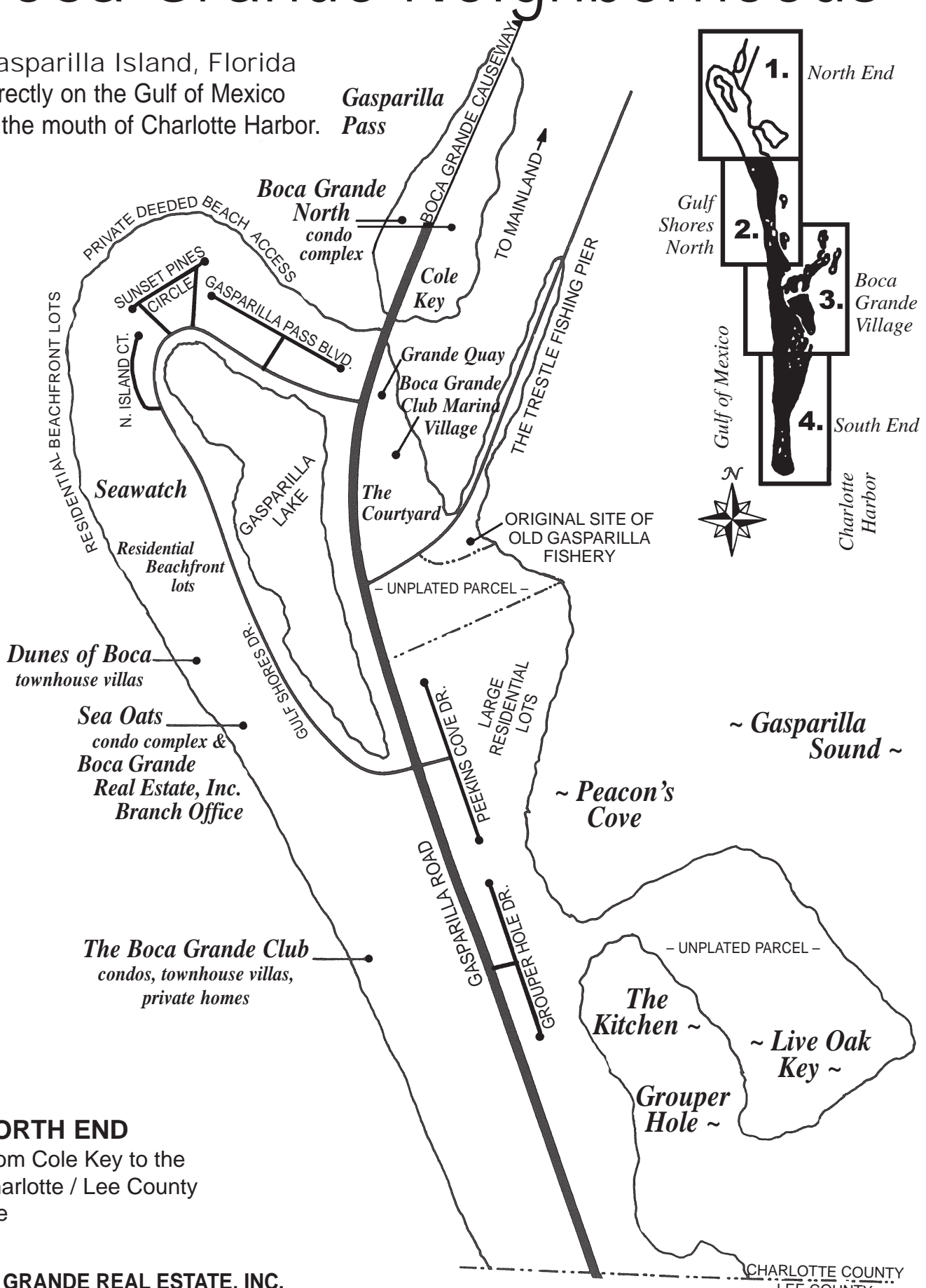

1. NORTH END
 From Cole Key to the
 ■ Charlotte / Lee County
 line

2. GULF SHORES NORTH

From the Charlotte / Lee County line to 19th St.

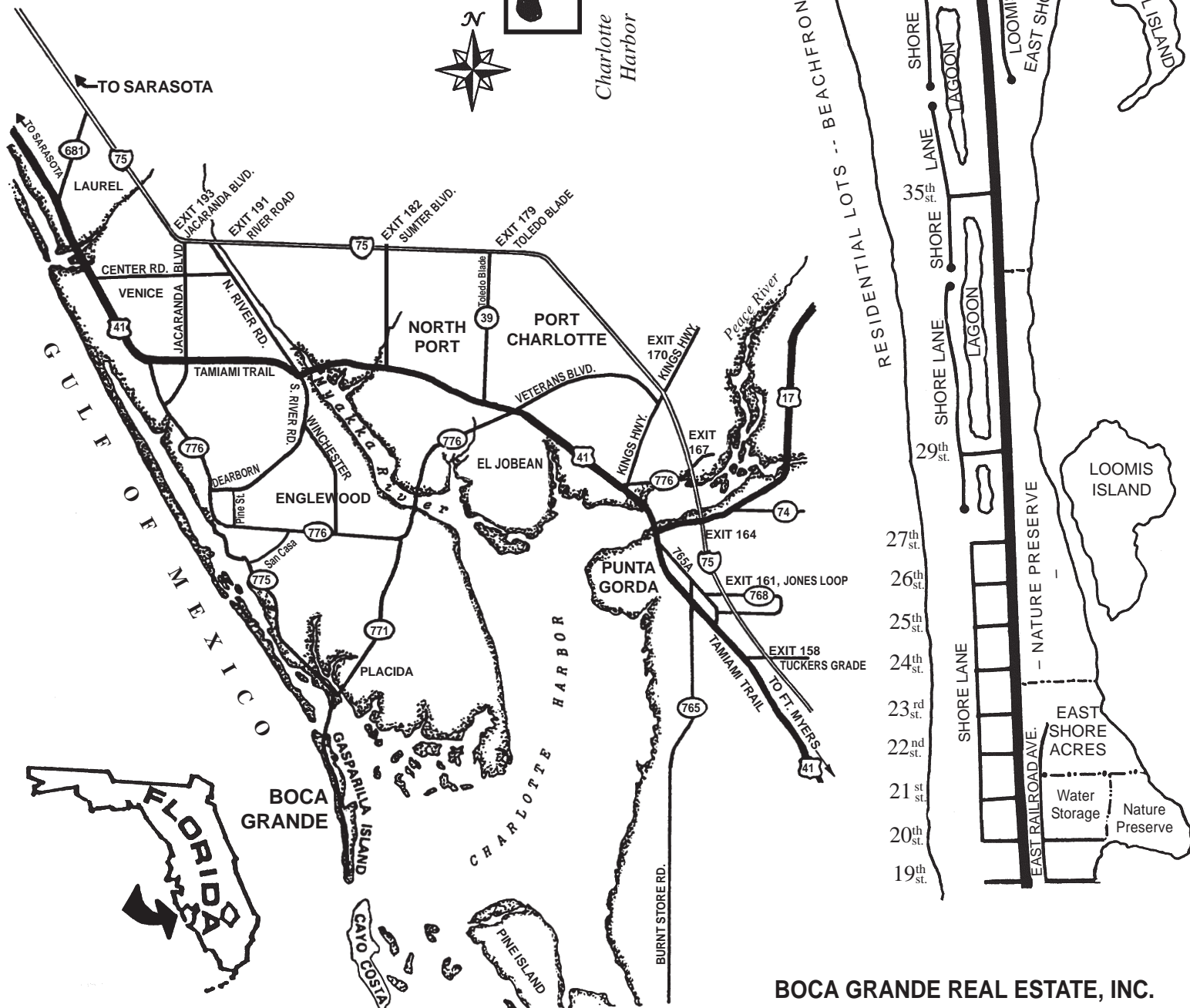
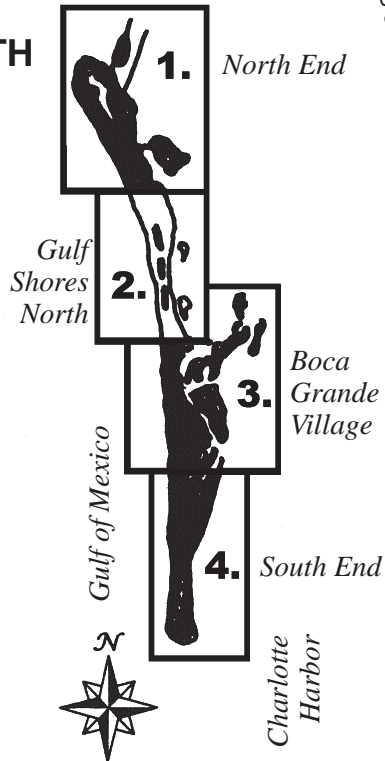

3. BOCA GRANDE VILLAGE

From 19th St. to First St.

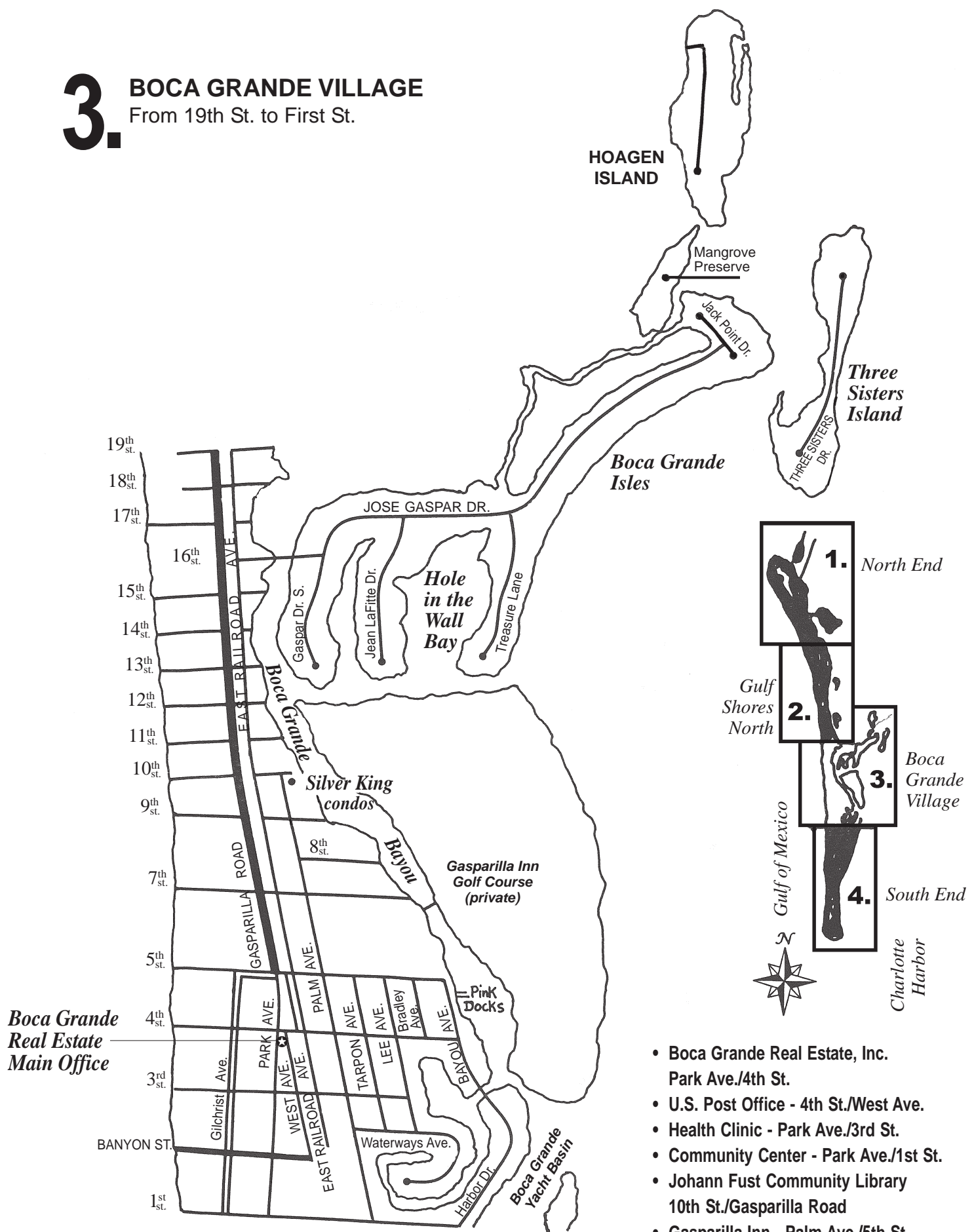

Boca Grande Real Estate Main Office

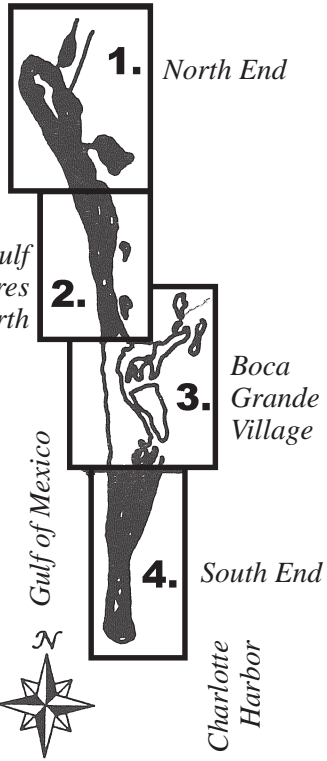

- Boca Grande Real Estate, Inc. Park Ave./4th St.
- U.S. Post Office - 4th St./West Ave.
- Health Clinic - Park Ave./3rd St.
- Community Center - Park Ave./1st St.
- Johann Fust Community Library 10th St./Gasparilla Road
- Gasparilla Inn - Palm Ave./5th St.
- Railroad Depot - Park Ave./4th & 5th St.

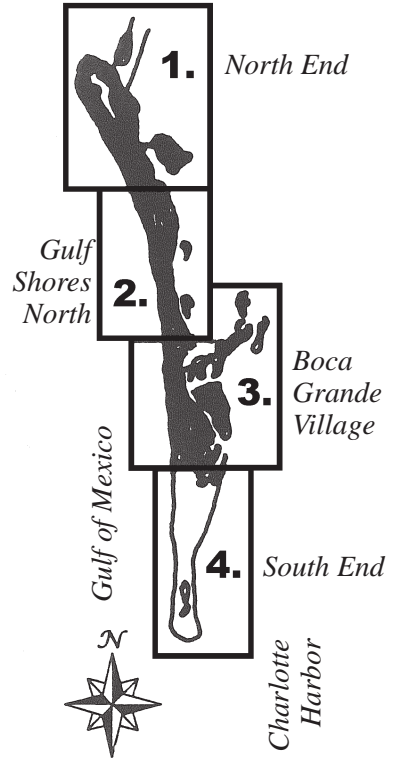
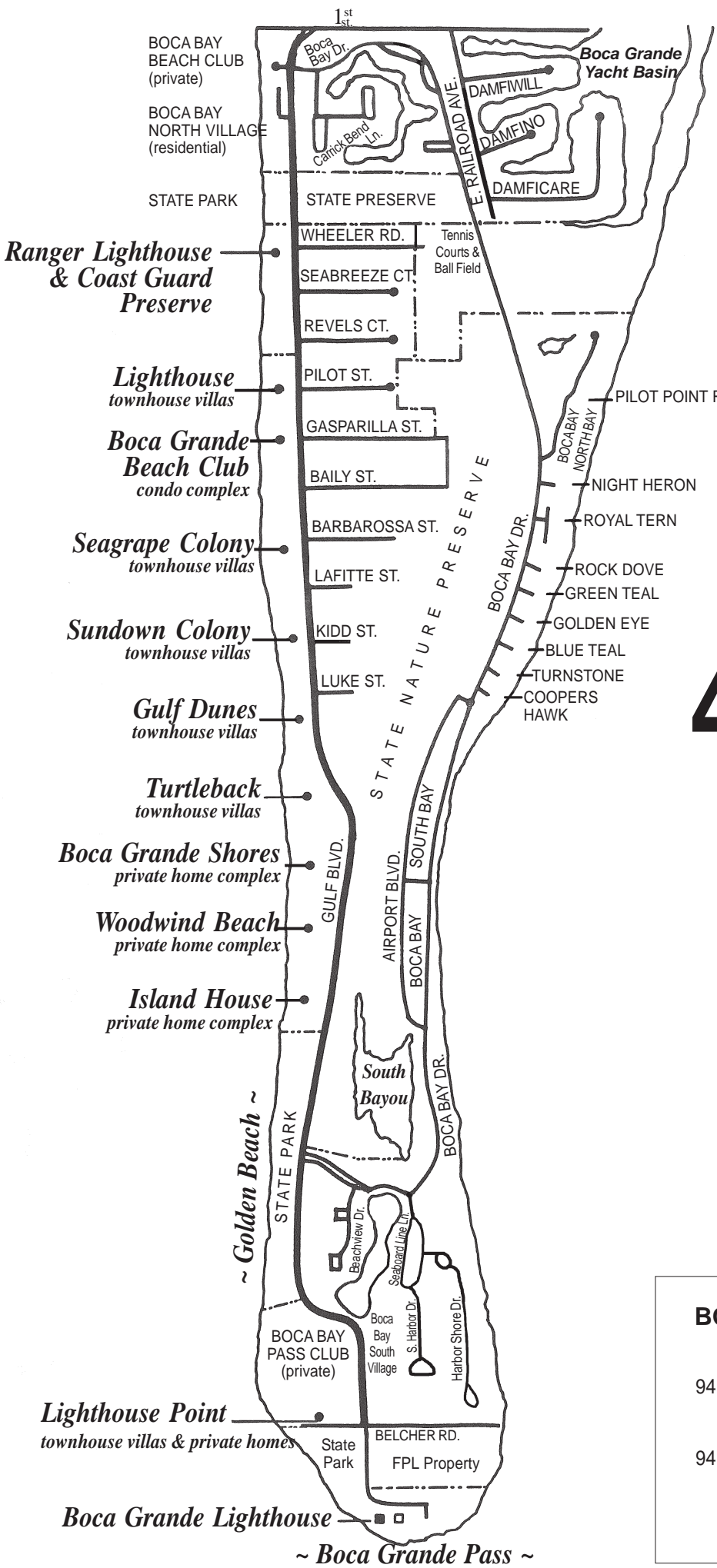

4. SOUTH END
From First St. to Boca Grande Pass

BOCA GRANDE REAL ESTATE, INC.
 MAIN OFFICE: Park Avenue
 941-964-0338 • 866-302-0338 • FAX: 941-964-2301
 SEA OATS BRANCH: 5700 Gulf Shores Dr.
 941-964-0987 • 800-881-6287 • FAX: 941-964-0993
 MAILING ADDRESS:
 P.O. Box 686, Boca Grande, FL 33921

Lighthouse Point
townhouse villas & private homes

Boca Grande Lighthouse

~ Boca Grande Pass ~